

- NOTES:  
 1. APPLY LOCTITE 262  
 2. APPLY LOCTITE 620  
 3. APPLY LOCTITE 242

REVISION HISTORY				
REV	DATE	DESCRIPTION	ECO	BY
A	8/29/2013	PRODUCTION RELEASE	14302	OT
B	9/15/2014	RUNOUT TOL 0.4mm	14786	OT

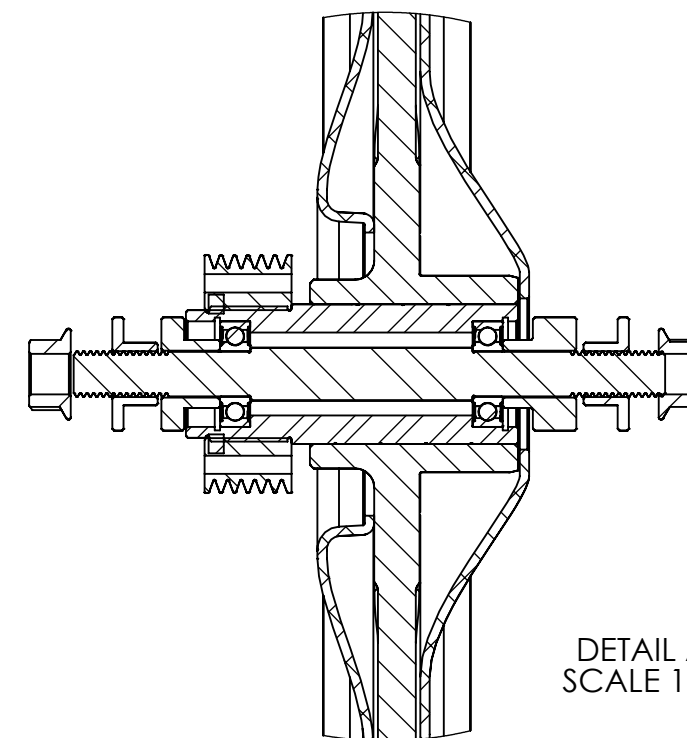
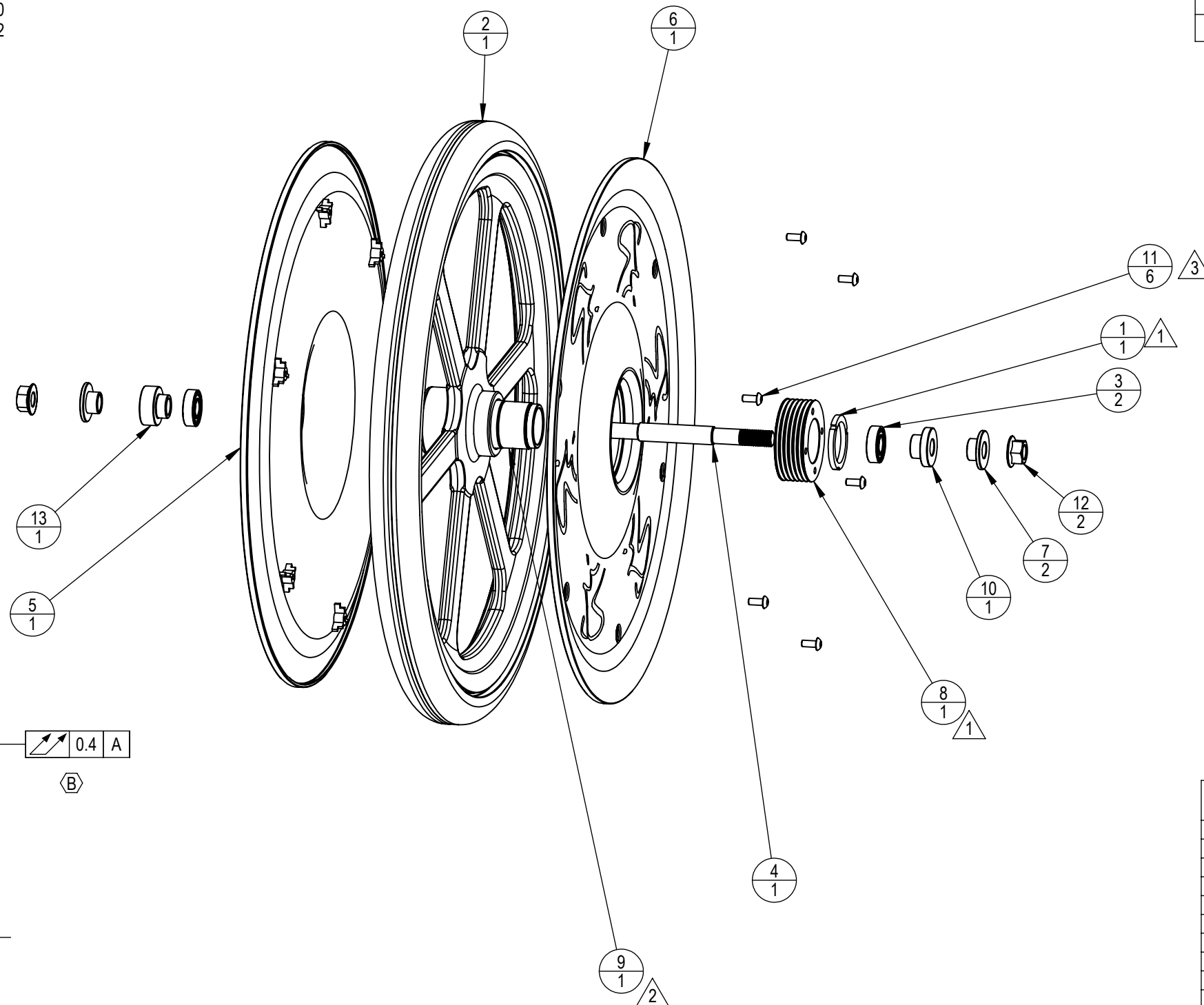

ITEM NO.	PART NUMBER	DESCRIPTION	QTY.
1	740-7114	RETAINING NUT	1
2	740-7578	FLYWHEEL, SPINNER	1
3	740-7580	BEARING, 6001-2RS	2
4	740-7582	SPINDLE, HUB, SPINNER	1
5	740-7810	SHROUD, FLYWHEEL, LEFT	1
6	740-7811	SHROUD, FLYWHEEL, RIGHT	1
7	740-7998	SPACER, FLYWHEEL, FLANGE	2
8	740-8533	PULLEY, FLYWHEEL, NXT BELT	1
9	740-8534	HUB, FLYWHEEL, SPINNER BELT	1
10	740-8536	SPACER, FLYWHEEL, SPINNER BELT, DR SIDE	1
11	731-0353	SCREW, M5X0.8, 12mm, BHC, HK	6
12	740-7190	NUT, M12X1.25, FLANGE, HE, CS, BO	2
13	740-8148	SPACER, FLYWHEEL, L	1

**DOCUMENT STATUS:**

NOTICE OF PROPRIETARY INFORMATION

THIS DOCUMENT SHALL NOT BE REPRODUCED NOR SHALL THE INFORMATION CONTAINED HEREIN BE USED BY OR DISCLOSED TO OTHERS EXCEPT AS EXPRESSLY AUTHORIZED BY CORE HEALTH & FITNESS, LLC.

CLASS OF WORK	UNLESS OTHERWISE SPECIFIED DIMS ARE IN mm. TOLERANCES FOR MEASURE OF LENGTH ARE:							ANGLES = ±2°
	0.5 to 3	>3 to 6	>6 to 30	>30 to 120	>120 to 400	>400 to 1000	>1000 to 2000	
FINE	±0.05	±0.05	±0.1	±0.15	±0.2	±0.3	±0.5	----
MEDIUM X	±0.1	±0.1	±0.2	±0.3	±0.5	±0.8	±1.2	±2
COARSE	±0.2	±0.3	±0.5	±0.8	±1.2	±2	±3	±4
VERY COARSE	----	±0.5	±1	±1.5	±2.5	±4	±6	±8

MATERIAL  
SEE BOM

FINISH  
N/A

VENDOR: N/A

P/N: N/A

THIRD ANGLE PROJECTION



**CORE HEALTH & FITNESS, LLC**

4400 NE 77th Ave., Suite 300  
Vancouver, WA 98662

DRAWN	INITIAL OT	DATE 8/29/2013
CHECKED		
APPROVED		

CORE PART NO <b>740-8535</b>	REV <b>B</b>
TITLE ASSY, FLYWHEEL, SPINNER BELT	
SCALE: 1:10	SHEET 1 OF 1
SHEET SIZE: B	